



*U dream... V build...*

## **Swarna Silicon Castle - *Minos***



Your next level of living...



*U dream... V build...*

## Swarna Silicon Castle - *Minos*



The design and areas mentioned are conceptual and subject to change. Furniture layout is indicative only. All dimensions indicated are before finishing

**Swarna constructions** is an emerging leader at the forefront of real estate. Winning a concrete reputation in construction over a decade of accomplishments, the company is presently engaged in developing prestigious projects in Karnataka and Andhra Pradesh. Taking pride in more than ten years of front line experience in real estate development and constructions, Swarna Constructions has successfully completed many excellent projects in and around the metros of Bangalore, Hyderabad and Visakhapatnam.

Swarna Constructions, a force to reckon with in construction industry, has established its credentials in acquiring the choicest properties with trouble free clean titles, and developing world class projects for both residential and commercial purposes. Swarna Constructions is now a trusted name for its quality construction, reasonable pricing, responsive management & truly flexible payment options.

# Swarna Constructions



U dream... U build...

### Swarna Silicon Castle - Minos



# Layout Plan



V dream... V build...

## Swarna Silicon Castle - Minos

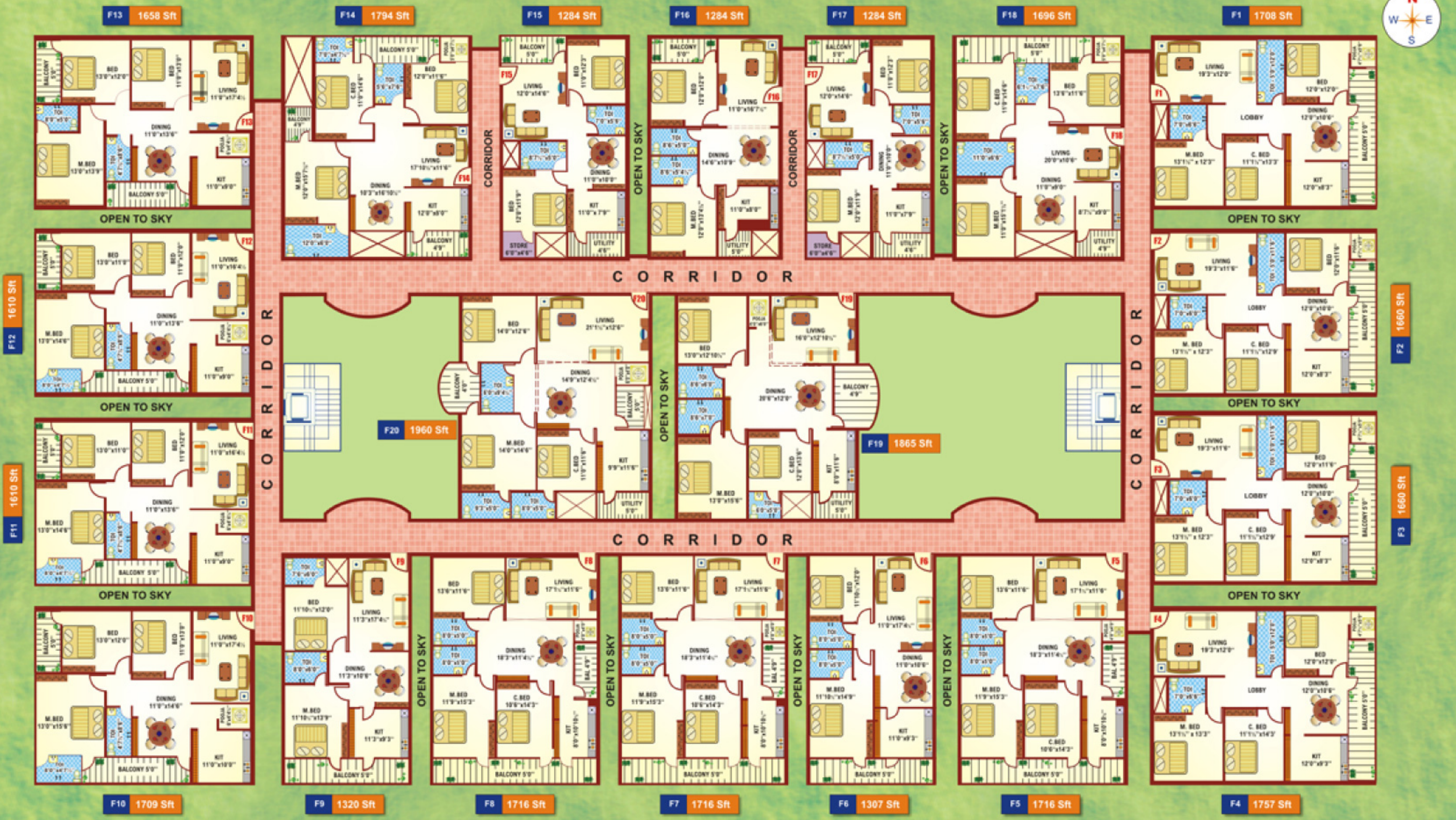

R - O - A - D - (East)

The design and areas mentioned are conceptual and subject to change. Furniture layout is indicative only. All dimensions indicated are before finishing



U dream... U build...

### Swarna Silicon Castle - Minos



## SPECIFICATIONS:

<b>Structure</b>	RCC Framed Structure with Cement block masonry and Cement plastering.
<b>Doors</b>	Polished Teak wood main door and all other doors with Sal wood frames and company made flush doors with enamel Paint.
<b>Windows</b>	Aluminum windows with Glass shutters and safety grills.
<b>Flooring</b>	Vitrified flooring for living/dining, Semi Vitrified flooring for Bedrooms, Anti skid tiles for Toilets and Kitchen.
<b>Painting</b>	Distemper for internal walls, exterior emulsion for external walls.
<b>Toilets</b>	Jaquar continental series/equivalent plumbing accessories, 50% color EWC & Wash basin and ceramic tiles dadoing.
<b>Electrical</b>	One TV and Telephone point in living and Master Bed room. Quality copper wiring with Anchor Roma/Equivalent Switches.
<b>Water supply</b>	Bore well and provision for municipal water.
<b>Vertical Access</b>	Two Lifts with Generator back-up and Two Staircases.
<b>Intercom</b>	Intercom facility from security enclosure to each flat.
<b>Parking</b>	Reserved covered car parking in stilt floor (above ground level)
<b>Value Additions</b>	<ul style="list-style-type: none"> <li>• Club house with Gymnasium</li> <li>• Mini Park</li> <li>• Play ground for Children</li> <li>• Table Tennis hall</li> </ul>

The design and areas mentioned are conceptual and subject to change. Furniture layout is indicative only. All dimensions indicated are before finishing



U dream... V build...

**Swarna Constructions**

a swarna group company

## Completed Projects:



Swarna Shines



Swarna Avalon

## Salient Features

- In the vicinity of International Tech Park, Star Hotels, Multinational Software Companies, International Schools and Super Speciality Hospitals.
- Low Rise building designed as per Seismic Zone 2 norms.
- Every Unit has been aesthetically designed as per Vastu.
- No common walls, Ample ventilation for all flats.



# Swarna Silicon Castle - Minos





This brochure is conceptual in nature and is by no means a legal offering. The promoters reserve the right to change, delete or add any specifications or plan mentioned herein.



*U dream... V build...*

**Swarna Constructions**

a swarna group company

Swarna, #159, 4th Main, BEML Layout, ITPL Road, Kundalahalli, Thubarahalli (Post), Bangalore – 560 066, India  
 Tel: +91(80)28476226, E-mail: info@swarnagroup.com, Website: www.swarnagroup.com

**Structural Consultants :**

**Tech Standards**

#54-11-13/4, Aditya Colony, Isukathota  
 Visakhapatnam - 530 013, India. Tel: +91(891)2702965

**Architects :**

**Design Arc-Tec**

F3, Mahalakshmi Enclave, Near Krishna College, Isukathota  
 Visakhapatnam-530 013, India. Tel :+91(891)2534901